

NOTE:
 1 HOUR CONSTRUCTION INDICATED.
 2-HR WALL CONSTRUCTION 2 LAYERS OF
 5/8" UL RATED GYPSUM BOARD

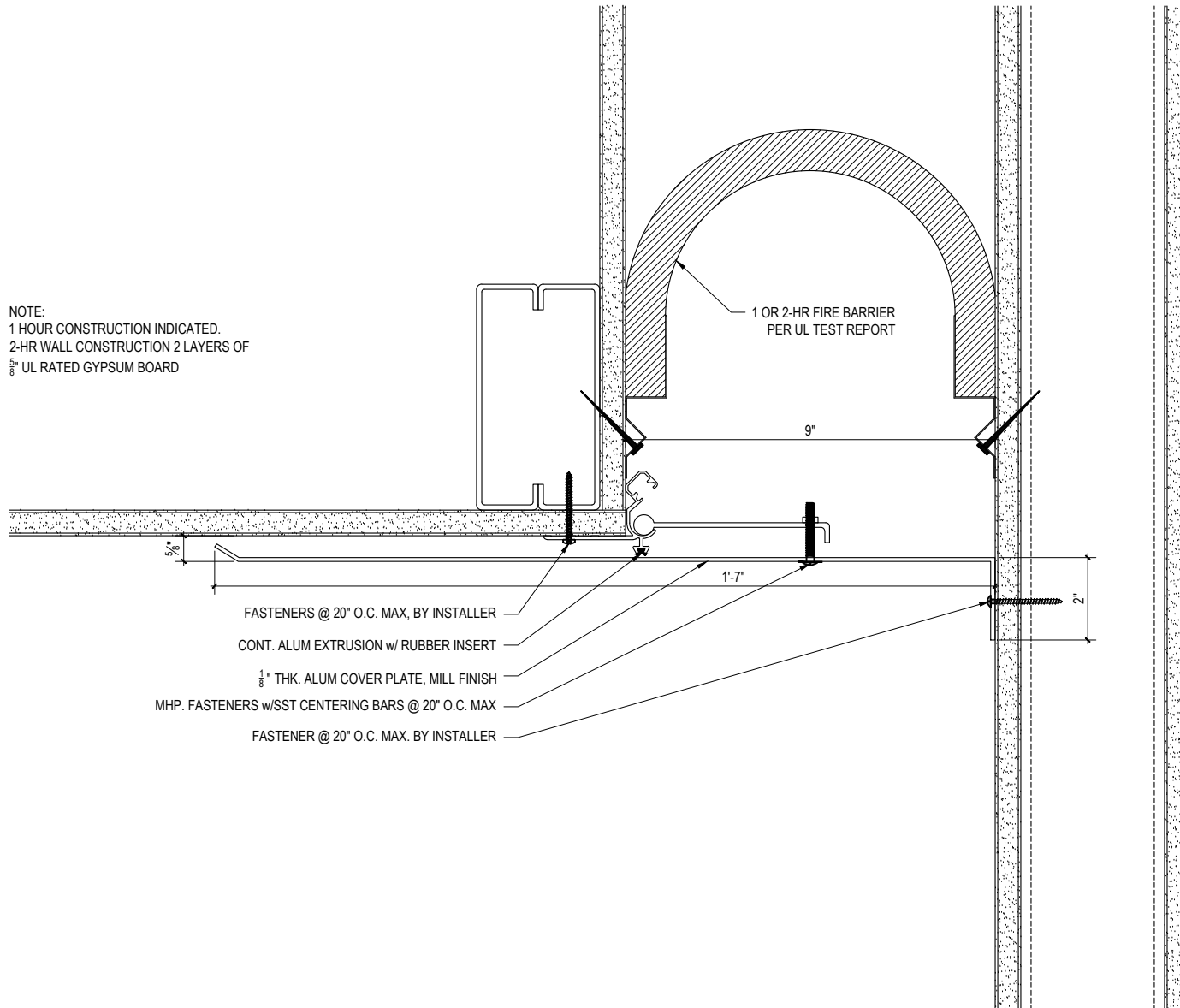

- FASTENERS @ 20" O.C. MAX. BY INSTALLER
- CONT. ALUM EXTRUSION w/ RUBBER INSERT
- 1/8" THK. ALUM COVER PLATE, MILL FINISH
- MHP. FASTENERS w/SST CENTERING BARS @ 20" O.C. MAX
- FASTENER @ 20" O.C. MAX. BY INSTALLER

SCALE: 3"=1'-0"



M.H. POWELL & CO., INC.
 ARCHITECTURAL SEISMIC EXPANSION JOINT SYSTEMS

2313 YATES AVENUE | PHONE : (323) 887-0037
 COMMERCE, CA 90040 | FAX : (323) 887-0877
 WEB : www.mhpowell.net

MODEL
WSL-9-9

WALL/CEILING CORNER CONDITION
 FIRE RATED

PROJECT : _____ PROJECT # : _____
 LOCATION : _____ DATE : _____
 ARCHITECT : _____
 CUSTOMER : _____

PAGE #